

## Model:

This installation manual is applicable to the LIGNE PRO Large series of embedded lighting fixtures, including models AOR165DT\*(Trimmed Bottom-illuminated), AOR175AT\*(Trimmed Adjustable Angle), AOR165WT\*(Trimmed Wall Washer), etc. The "\*" includes information on different powers, control systems, color temperatures, face frames, and finish color of the fixtures.

## Installation Precautions:

1. Please read through the Instructions before installation.
2. The product should be installed by a professional electrician.
3. Make sure the power supply is cut off before installation and maintenance, to avoid the risk of electric shock.
4. The light can be recessed on the ceiling, where sufficient space must be reserved for installation. Do not cover the light with any thermal insulation or consumable articles to avoid fire hazards.
5. In case of cracking of glass, please replace it immediately.
6. Do not install the light on an unstable or unsolid skylight, to avoid falling off.
7. Please keep this Instruction properly for future reference.
8. The LED source in the light should be replaced by the manufacturer or its service agent or similarly qualified personnel.

## Light Installation and Wiring:

Model	Cutout dimension	Minimum installation space (h)	Range of installable ceiling thickness (D)
AOR165DT-06*	91×48 mm	90 mm	5~25
AOR175AT-06*	103×59mm	100 mm	5~25
AOR165DT-11*	167×48mm	90 mm	5~25
AOR165WT-11*		90 mm	5~25
AOR175AT-11*	180×59mm	100 mm	5~25
AOR165DT-22*	320×48mm	90 mm	5~25
AOR165WT-22*		90 mm	5~25
AOR175AT-22*	332×59mm	100 mm	5~25
AOR165DT-32*	469×48mm	90 mm	5~25
AOR165WT-32*		90 mm	5~25
AOR175AT-32*	486×59mm	100 mm	5~25

1. Select the corresponding ceiling opening size according to the specifications and models of the lighting fixtures, and pre open the installation holes for the lighting fixtures on the ceiling (as shown in Figure 1);

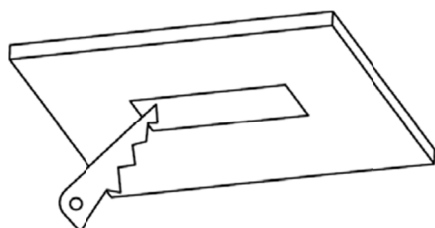

Figure 1

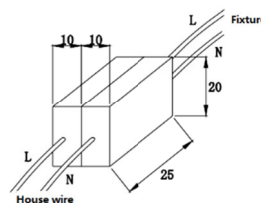

Figure 2

2. Open the drive input terminal box cover, insert the positive and negative terminals of the mains power into the L and N terminals of the wiring terminals, and after wiring is completed, replace the box cover; If the lamp is a dimming model, open the drive output terminal box cover and insert the dimming control wire into the "10V+" and "10V -" holes of the wiring terminal. After wiring is completed, the box cover

needs to be replaced.

3. The driver of the lighting fixture comes with a lead wire, which needs to be connected to an independent terminal block (refer to the schematic diagram in Figure 2 for wiring). The size of each terminal block should not be less than 10x20x25mm.

## Installation for Trimmed Downlight and Trimmed Wall Washer

For the models of Trimmed Downlight(AOR165DT\*) and Trimmed Wall Washer(AOR165WT\*), after connecting the wires, place the driver through the cutout opening. Then, twice the installation spring and mount the fixture into the ceiling opening. After installation, confirm the fixture is securely mounted, as shown in Figure 3 and 4.

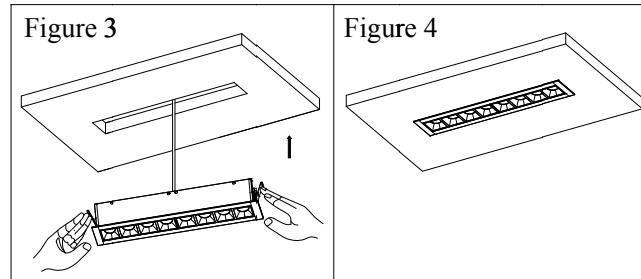

## Installation for Trimmed Angle Adjustment

For the AOR175AT\* Trimmed Adjustable Angle model: Place the driver into the ceiling through the opening after connecting the wires. Then twist the installation spring clip into the ceiling opening. After installation, confirm the fixture is securely mounted, as shown in Figure 5, Figure 6 and Figure 7.

Note: Figure 5 shows the installation of 2, 4, and 8 Trimless Angle Adjustment(AOR175AT-06\*, AOR175AT-11\*,AOR175AT-22\*). Figure 6 shows the installation of 12 Trimless Angle Adjustment(AOR175AT-32\*)

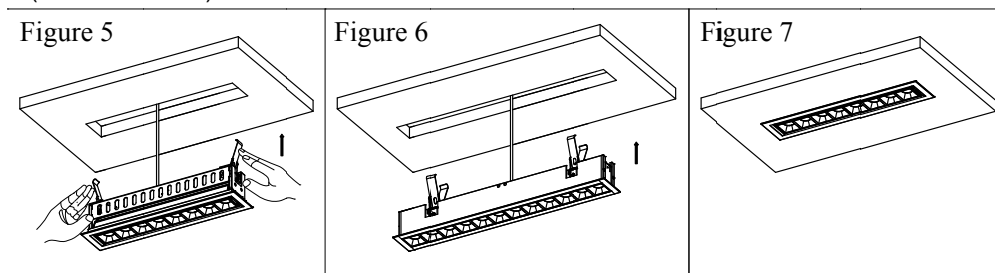

## Installation for Trimmed Angle Adjustment

For Angle Adjustment model(AOR175AT\*), the fixture can be adjusted in both directions. As shown in Figure 8 and 9, use a flat screwdriver to simply adjust the lighting angle with a range of  $\pm 35^\circ$ .

