

## Installation Precautions:

1. Please read through the Instructions before installation.
2. Install by a qualified electrician, confirm to turn off the power before installation and maintenance;
3. Suitable for indoor installation (not for humid environment);
4. **Lamps can not be directly connected to the mains 220V, need to be used together with electrical appliances, the use of dimming system, need to do a good match test with electrical appliances in advance.**
5. The luminaire can be recessed into the ceiling surface. Do not cover the area above the luminaire with thermal insulation materials or combustible materials to prevent fire hazards.
6. Do not install the luminaire on unstable or insecure skylights to prevent the luminaire from falling.
7. The light source of this lamp is not replaceable, once it needs to be replaced (such as the end of the life of the light source), the entire lamp should be replaced;
8. Keep this manual properly for use when needed.

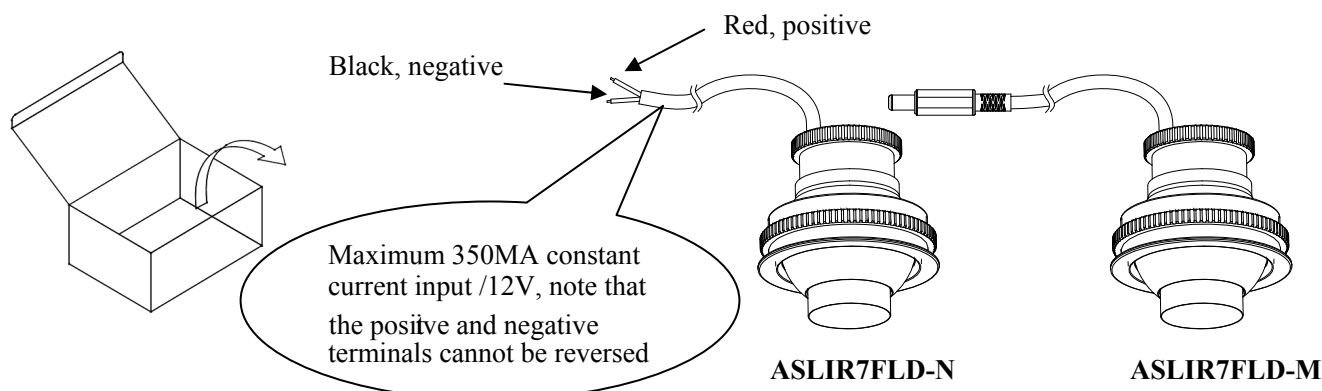

## Electrical appliance selection:

ASLIR7FLD-M	It is used with WAC MTB power divider
ASLIR7FLD-N	WAC brand Appliance: 4LD-350MA10D-LF-C (3-20V) (order separately)

**Lighting installation:** Cutout:  $\varnothing 29$  mm; Ceiling thickness: 1 – 10 mm

Tighten the rear fixing ring fully. Improper installation will affect luminaire adjustment.

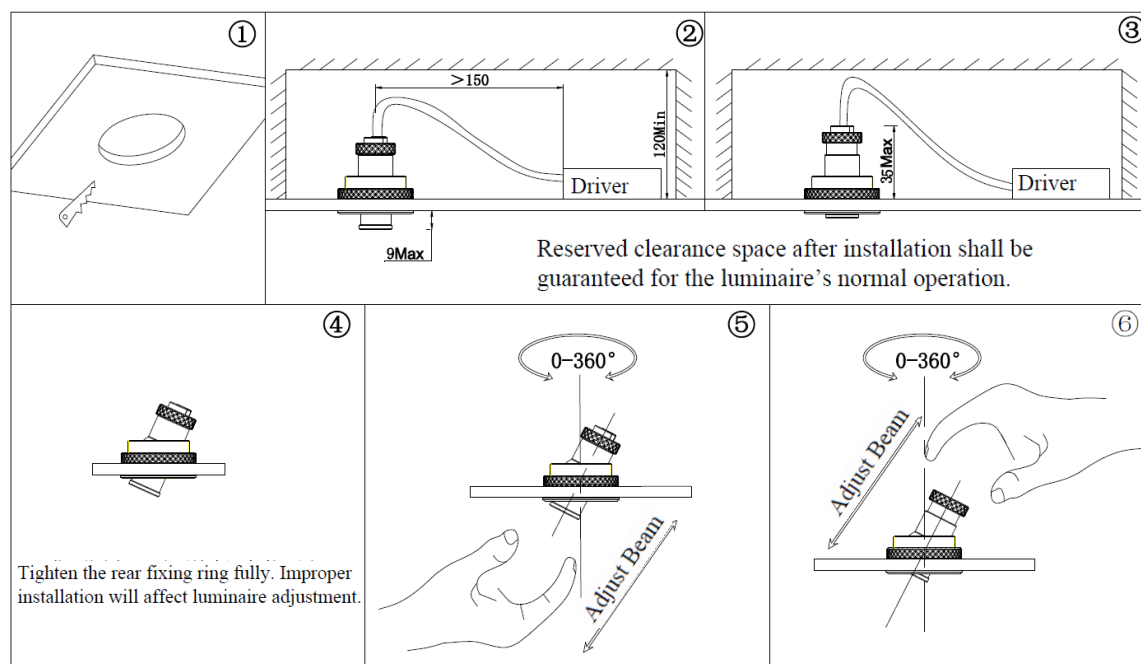

Licensed by "WAC" trademark holder - WAC LIGHTING, USA

Chinese Marketing Headquarters

Address

China factory

Address

: WAC Lighting (Shanghai) Co, Ltd.

: 14, Lane 299, Bi Sheng Road, Shanghai 201204, China

: Manufactured WAC Lighting (Dongguan) Co, Ltd.

: 390, Qingfeng Road, Qingxi Town, Dngguan, Guangdong. Postal code: 523653