

## Installation Precautions:

1. Please read through the Instructions before installation.
2. The lighting system must be installed by qualified professional electricians and comply with national and local laws and regulations.
3. To reduce the risk of fire, electric shock, and personal injury, the main power switch must be turned off before installing or modifying the system.
4. Please keep this manual for future maintenance reference.
5. Failure to install the lighting fixtures according to the instructions will result in no quality assurance.

## Installation accessories (random delivery):



Salad head screw

Quantity: 2pcs



Spiral cap

3pcs



Retaining screw

2pcs



Allen key

1pcs

## Installation and wiring of lighting fixtures:

**Junction box:** The opening size is  $74 \times 118$  mm. The diameter of the waterproof power cord is  $\phi 6-8$ mm.

1. When installing junction boxes outdoors, it is necessary to ensure their sealing and prevent water leakage.
2. Wiring connection between lighting fixtures and junction boxes: The brown wire of the lamp is connected to the live wire, the blue wire is connected to the neutral wire, and the yellow green wire is connected to the ground wire.(as shown in Figure 1). **Note: Multiple lamps (up to 200) can be used in parallel.**
3. Place all wires and connecting terminals into the junction box before installing the lighting fixture (as shown in Figure 2). **Attention: When installing in outdoor or indoor humid environments, it is necessary to keep the installation position dry. To prevent water leakage inside the lamp, outdoor waterproof silicone must be used.**
4. Install the cover, fasten it (as shown in Figure 3), and use the matching hex wrench to tighten the locking screw (as shown in Figure 4).

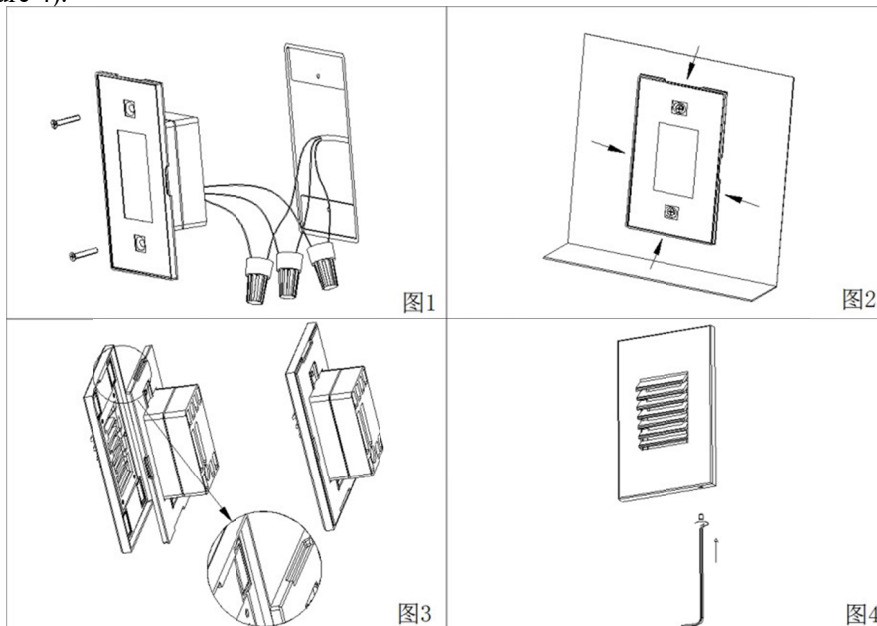

Licensed by "WAC" trademark holder - WAC LIGHTING, USA

Chinese Marketing Headquarters

Address

China factory

Address

: WAC Lighting (Shanghai) Co., Ltd.

: 14, Lane 299, Bi Sheng Road, Shanghai 201204, China

: Manufactured WAC Lighting (Dongguan) Co., Ltd.

: 390, Qingfeng Road, Qingxi Town, Dngguan, Guangdong. Postal code: 523653